

911 SIGNAL TECHNOLOGY INC.

Tel:+86-574-89017911 +86-400-6757-911

Fax:+86-574-82822560

Email:sales@911signal.com

Website:www.911signal.com

Add:Room701-702,Hengwei Building,No.258,  
Tangao Lane,  
Shouan Subdistrict,Yinzhou Area,Ningbo  
City,Zhejiang,China.

**911** *SIGNAL*<sup>®</sup>

**Worklight  
V30**



## CAUTION



Keep away from corrosive substances.

Keep away from fire.



Avoid direct look into the light.



Keep hands away from operating lights to prevent burns.

Disassembly is not allowed.



## FEATURE

- Robust design and streamline shape makes V30 a good fit to your machinery or vehicle.
- Its ergonomic plastic handle isolates the heat and makes carrying the light effortless.

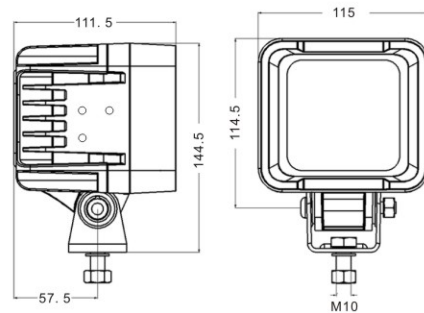

## V30-LR PRODUCT SPECIFICATION

Item	Voltage	Power	Lux	Lumen	LED	Color Temp	Certificate
120101	DC 9-33V	43W	140lx(10M)	3000lm	16Pcs 5W LED	7000K	R10

Item	120101
Long-Range Illumination	x
Cable	x

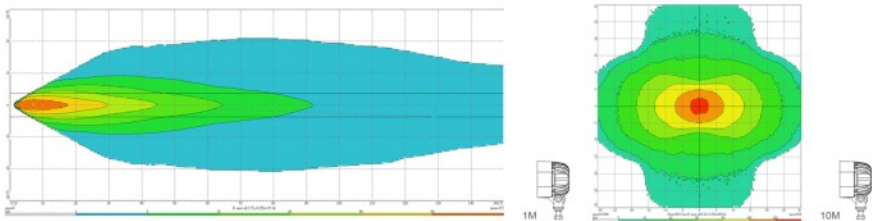

## V30-CR PRODUCT SPECIFICATION

Item	Voltage	Power	Lux	Lumen	LED	Color Temp	Certificate
120151	DC 9-33V	43W	140lx(10M)	3000lm	16Pcs 5W LED	7000K	R10

Item	120151
Close-Range Illumination	x
Cable	x

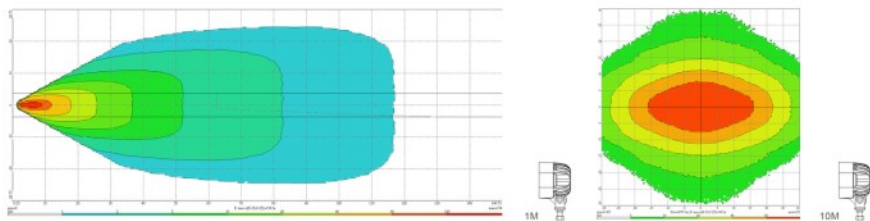

## COMPONENTS

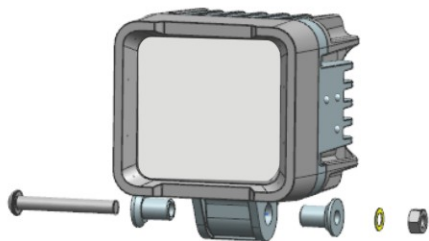

① (Standard)

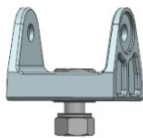

② (Optional)



③ (Optional)



④ (Optional)



⑤ (Optional)

You can choose from five brackets.

## BRACKETS

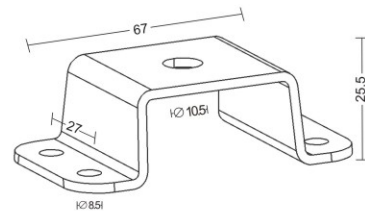
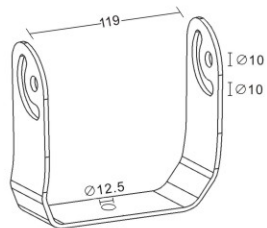
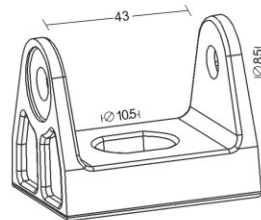
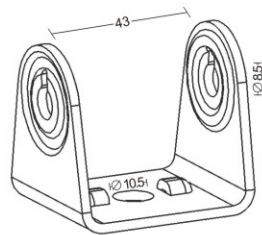

## COMPONENTS

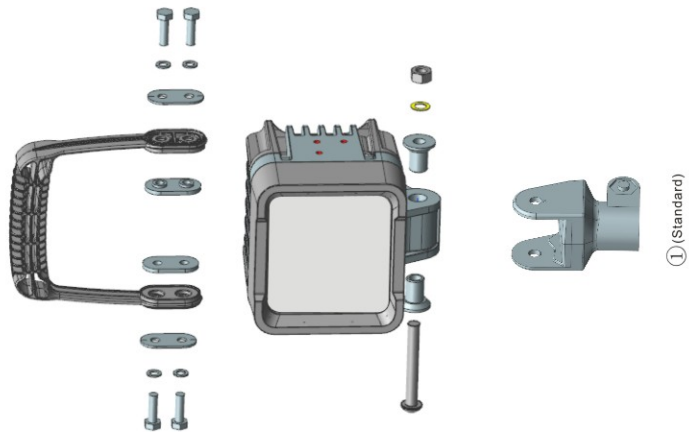

## BRACKETS

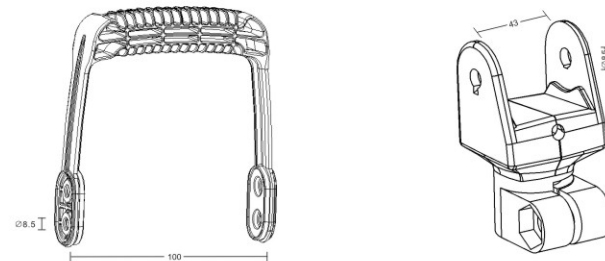

Assembly of the handle and the bracket.

## MOUNTING OPTIONS

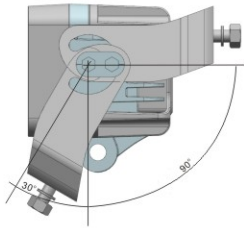
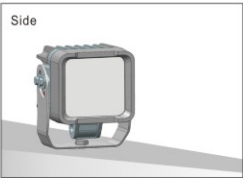

## MOUNTING OPTIONS

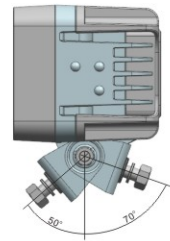
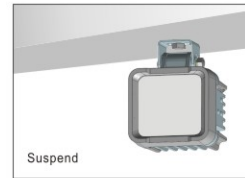
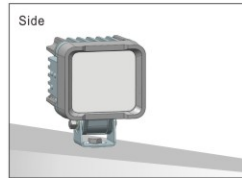

## MOUNTING OPTIONS

Only vertical mount is allowed.

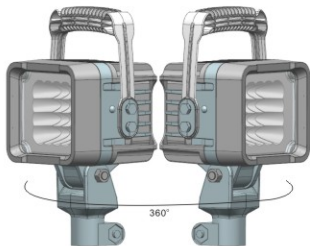

## APPLICATION



Tractor



Combined Harvester



Excavator



Fire Truck



Tow Truck



Forwarder



Truck



Forklift



Ambulance



Snow Plough

## WIRING DIAGRAM

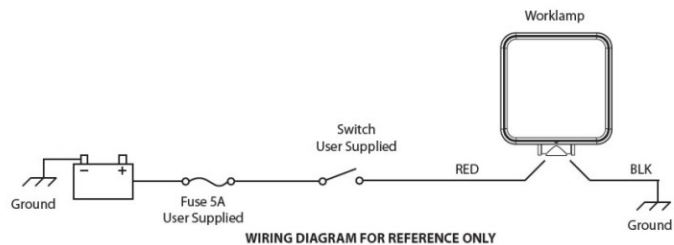

## NOTE