



C12-E LED Beacon

Features

- > Upgraded to be the most economical beacon with great quality
- > Meets and exceeds SAE, ECE R65 and R10
- > Unique LED reflectors provide a superior warning signal
- > 22 built-in user selectable flash patterns
- > Multiple mounting options including single point, 3 points, magnetic and flexi din
- > Deformation of rubber base (flexi din exclusive) prevents the dome being damaged in any accidents
- > Low amp draw and bright output makes it an ideal beacon for everyday use

Item	080405	080402
Color	Single	
Voltage	10-33VDC	
Max Power	18W	
Lens	Reflex	
LED	12pcs 3W	
Flash Patterns	22	
Operating Temperature	-30 to 70°C	
Mounting	Single Point, Three Bolts, Magnetic, Flexi-Din	

Mounting

Three Bolts

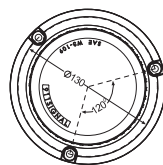
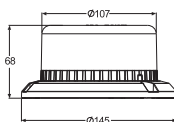

Magnetic

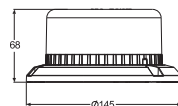

Single Point

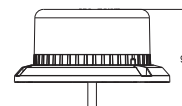

Flexi Din

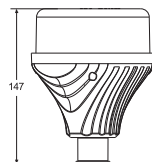

911 Signal Technology Inc.

China Office

Tel: +86-574-89017911

Fax: +86-574-82822560

Email: sales@911signal.com

France Office

Tel: +33(0)659163209

Email: euoffice@911signalgroup.com

www.911signal.com

